

C111 Series

IDC Socket, 2.0mm(0.079")

Specifications:

Contact Resistance: 30mΩ @ 100mADC
 Insulator Resistance: 1000MΩmin. @ 500VDC
 Current Rating: 1AMP
 Voltage: 500VAC For 1 minute
 Operating Temperature: -55°C ~ +105°C
 Contact: Brass Phosphor Bronze, Stamped
 Housing: PBT, UL94V-0

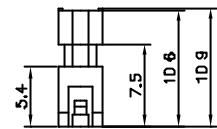
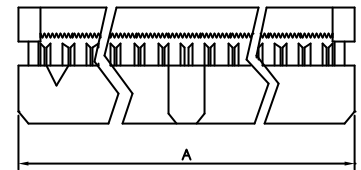
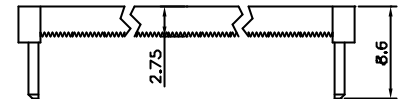
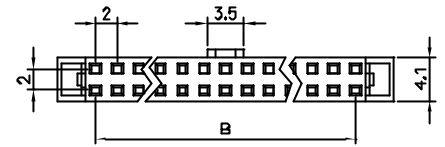

Ordering Information

C111-26TAK

Series No. | Insulator Colour:
 No. of Pins: | K-Black
 08, 10, 14, 16, 20, | G-Gray
 24, 26, 30, 34, 40, | Strain Relief:
 44, 50, 60, 64 | A-Strain Relief
 Contact Plating: | B-W/O Strain Relief
 G-All Gold Plated
 T-Tinned Terminal
 & Gold Plated Contact

Positions	A	B	Positions	A	B
08	13.2	6.0	30	35.2	28.0
10	15.2	8.0	34	39.2	32.0
14	19.2	12.0	40	45.2	38.0
16	21.2	14.0	44	49.2	42.0
20	25.2	18.0	50	55.2	48.0
24	29.2	22.0	60	65.2	58.0
26	31.2	24.0	64	69.2	62.0

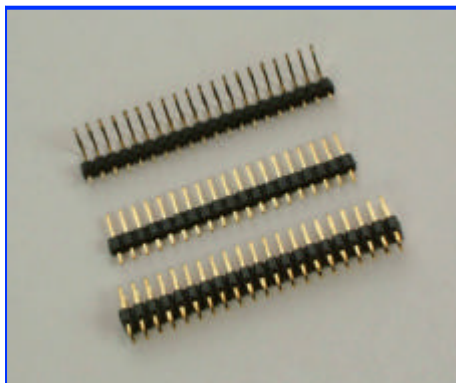

C112-A Series

Pin Header, 2.54mm(0.100")

Specifications:

Contact Resistance: 30mΩ @ 100mADC
 Insulator Resistance: 1000MΩmin. @ 500VDC
 Current Rating: 1AMP
 Voltage: 500VAC For 1 minute
 Operating Temperature: -55°C ~ +105°C
 Contact: Brass or Phosphor Bronze, Stamped
 Housing: PBT, UL94V-0

<Single Row>

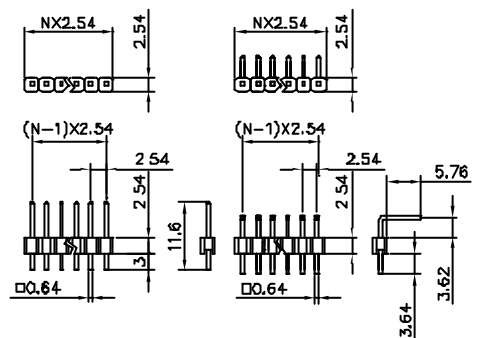

<Dual Row>

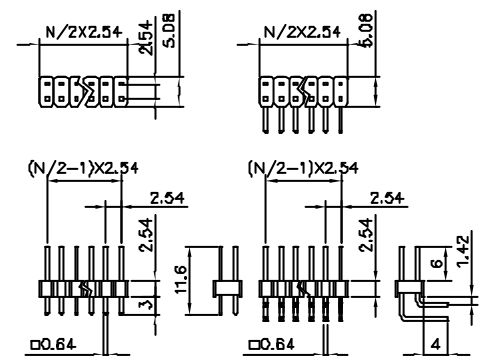

Ordering Information

C112-A-DS80G

Series No. | Contact Plating:
 D-Dual Row | T-Tinned
 S-Single Row | G-Gold Flash All Over
 Pin Direction: | No. of Pins:
 S-Straight | 02~40 for Single Row
 R-Right Angle | 04~80 for Dual Row

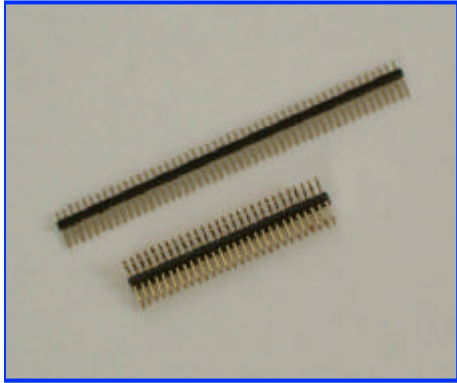

C112-B Series

Pin Header, 1.27mm (0.050")

Specifications:

Contact Resistance: 30mΩ @ 100mADC
 Insulator Resistance: 1000MΩmin. @ 500VDC
 Current Rating: 1AMP
 Voltage: 500VAC For 1 minute
 Operating Temperature: -55°C ~ +105°C
 Contact: Brass or Phosphor Bronze, Stamped
 Housing: Nylon 6T, UL94V-0

<Right Angle>

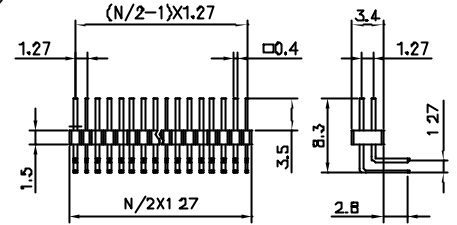

<Straight>

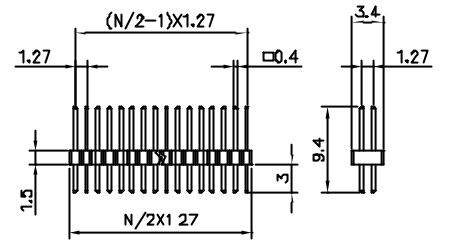

Ordering Information

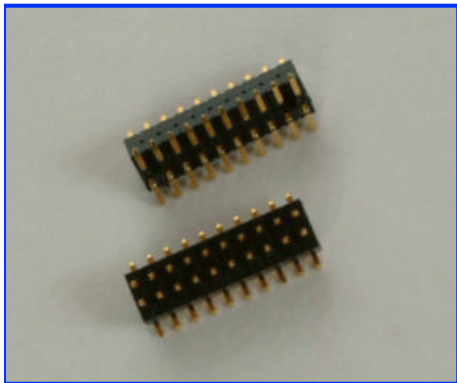
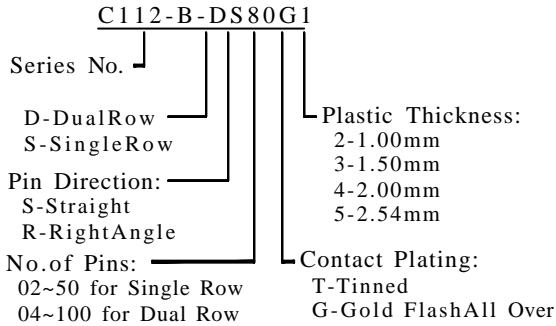

C112-C Series

Pin Header, 1.27mm (0.050"),
 SMT Type, Locating Peg

Specifications:

Contact Resistance: 30mΩ @ 100mADC
 Insulator Resistance: 1000MΩmin. @ 500VDC
 Current Rating: 1AMP
 Voltage: 500VAC For 1 minute
 Operating Temperature: -55°C ~ +105°C
 Contact: Brass or Phosphor Bronze, Stamped
 Housing: Nylon 6T, UL94V-0

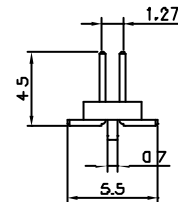
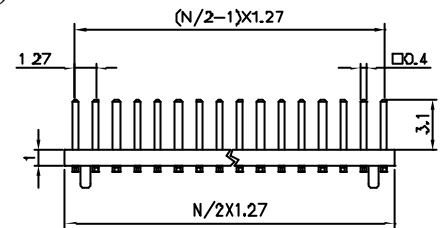

Ordering Information

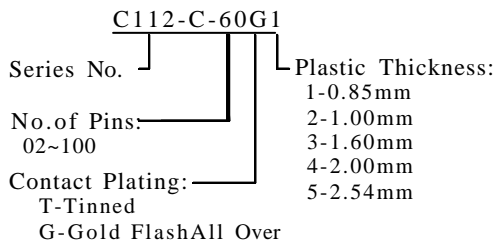

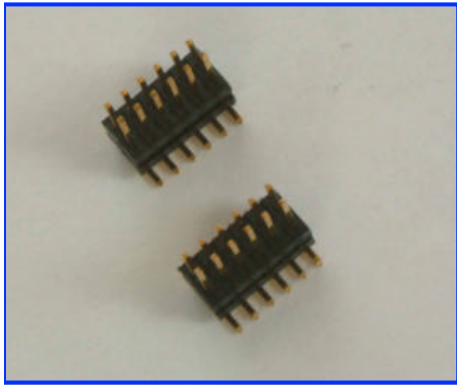

C112-D Series

**Pin Header, 1.27mm (0.050"),
SMT Type**

Specifications:

Contact Resistance: 30mΩ @ 100mADC
 Insulator Resistance: 1000MΩmin. @ 500VDC
 Current Rating: 1AMP
 Voltage: 500VAC For 1 minute
 Operating Temperature: -55°C ~ +105°C
 Contact: Brass or Phosphor Bronze, Stamped
 Housing: Nylon 6T, UL94V-0

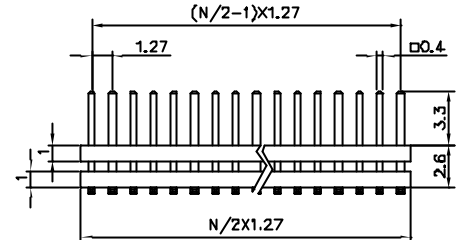

Ordering Information

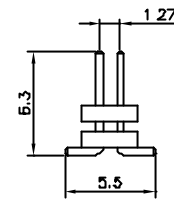
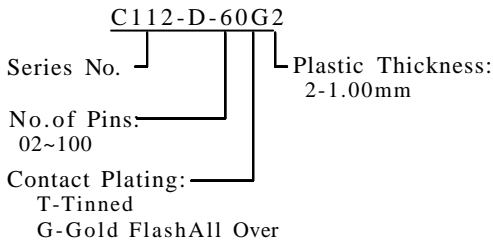

C113 Series

Pin Header, 2.0mm (0.079")

Specifications:

Contact Resistance: 30mΩ @ 100mADC
 Insulator Resistance: 1000MΩmin. @ 500VDC
 Current Rating: 1AMP
 Voltage: 500VAC For 1 minute
 Operating Temperature: -55°C ~ +105°C
 Contact: Brass or Phosphor Bronze, Stamped
 Housing: PBT, UL94V-0

<Single Row>

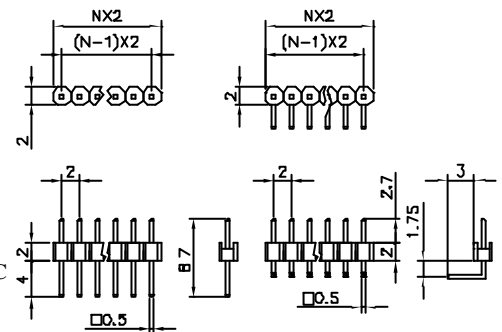

<Dual Row>

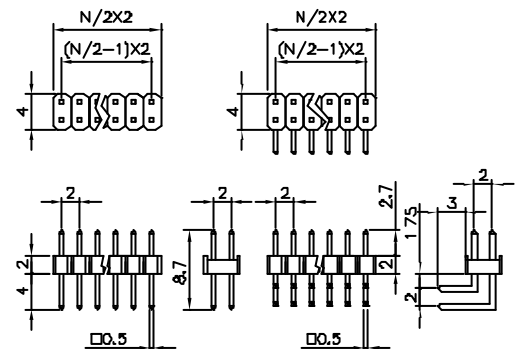

Ordering Information

